

IzoRoof MWF

Roof sandwich panel with mineral wool core.
High surface profile.

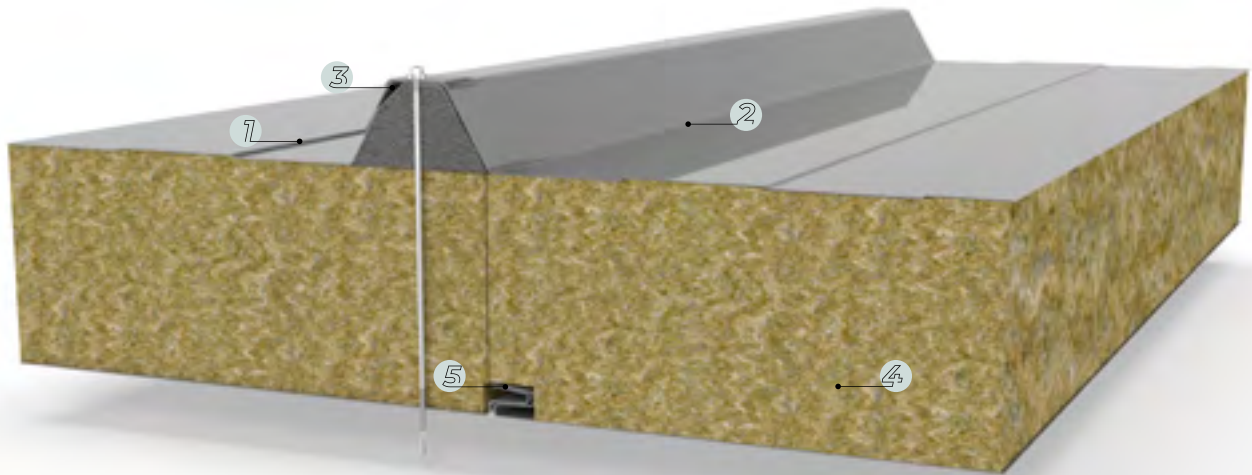
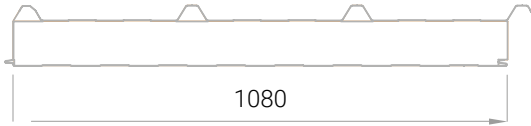

1 Profiled lining with a unique surface design.

4 Core made of hard incombustible mineral wool (MWF).

2 Large bend radii guarantee durability of lining protective coatings.

5 Profiled edges guarantee tightness of joint.

3 Capillary action preventing chamber.

Mineral wool core, $\lambda = 0,040 \text{ W/m}^2\text{K}$.

Steel sheet lining with anticorrosive protection depending on the intended use.

- production halls
- storage buildings
- commercial halls
- shopping centres
- farm facilities

Suitable for roofs of industrial buildings.

Mechanical properties

<i>thickness [mm]</i>	80	100	120	150	200
<i>modular width [mm]</i>	1080				
<i>total width [mm]</i>	modular width +74 mm				
<i>length [mm]</i>	2000 - 13000*				
<i>weight 0,5/0,5 [kg/m²]</i>	17,8	20,0	22,2	25,5	31,0
<i>weight 0,5/0,6 [kg/m²]</i>	18,7	20,9	23,1	26,4	31,9
<i>weight 0,6/0,6 [kg/m²]</i>	19,6	21,8	24,0	27,3	32,8

Insulating power

<i>U [W/m²K]*</i>	0,48	0,39	0,33	0,26	0,20
------------------------------	------	------	------	------	------

Burning behaviour

<i>fire resistance</i>	REI 60
<i>reaction to fire</i>	A2-s1, d0
<i>fire propagation</i>	R _{BROOF} (t1)

Acoustic properties

<i>acoustic resistance coefficient:</i>	
<i>R_w [dB]</i>	32
<i>R_{A1} [dB]</i>	31
<i>R_{A2} [dB]</i>	28
<i>acoustic absorption coefficient a_w</i>	0,15

Leakproofness

<i>Air permeability: pressure</i>	n = 0,6662, C = 0,0177
<i>Air permeability: suction</i>	n = 1,2430, C = 0,0044
<i>Blowing rain resistance</i>	A class - absolute leakproofness at 1,200 Pa
<i>Corrosion resistance</i>	External claddings: RC3, internal claddings: RC2 **

* maximum length depending on the panel colour – see the "Tips for colour selection" section

** The RC2 corrosion resistance class refers to standard corrosion protection used only on internal cladding. Higher corrosion resistance category on special order.