

IzoCold PIR/PIR+

Cold store panel with polyisocyanurate or polyurethane core.

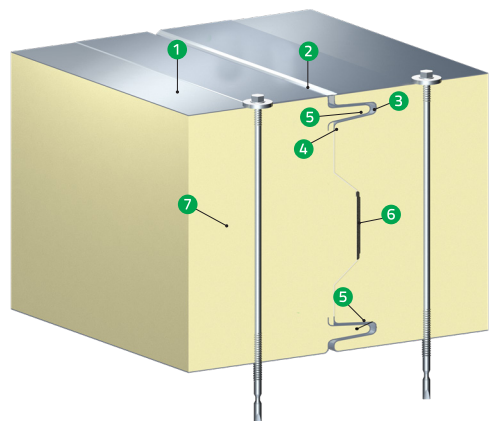

- 1 Profiled lining with a unique surface design.
- 2 Sealant applied at the construction site (optional).
- 3 Large bend radii guarantee durability of lining protective coatings.
- 4 Profiled edges facilitate assembly and ensure proper thermal insulating power.
- 5 Double panel lock guarantees best fire resistance properties.
- 6 Labyrinth core joint eliminates thermal bridge.
- 7 Core made of stiff, freon-free, self-extinguishing PIR/PIR+ foam with very good thermal insulation properties..

Suitable for external and internal walls as well as ceilings and suspended ceilings of cold stores and freezers. These panels should be installed outside building structure.

PIR/PIR+ core - stiff polyisocyanurate foam, thermal conductivity rating $\lambda = 0,022 \text{ W/m}^2\text{K}$, improved burning behaviour.

Steel sheet lining with anticorrosive protection depending on the intended use.

Mechanical properties						
thickness	120	140	160	180	200	220
modular width [mm]	1150 or 1080* or 1000*					
total width [mm]	modular width +18 mm					
length [mm]	2000 - 16000**					
weight 0,5/0,4 [kg/m ²]	12,2	13,0	13,8	14,6	15,4	16,2
weight 0,5/0,5 [kg/m ²]	13,0	13,8	14,6	15,4	16,2	17,0
Insulating power						
U PIR/PIR+ [W/m ² K]	0,18	0,16	0,14	0,12	0,11	0,10
Burning behaviour						
PIR fire resistance	EI 15	EI 15	EI 15	EI 15	EI 15	EI 15
PIR+ fire resistance	EI 30	EI 30	EI 30	EI 30	EI30/EI60***	EI30/EI60***
PIR+ reaction to fire	B-s1, d0					
PIR reaction to fire	B-s2, d0					
fire propagation	NRO					
Acoustic properties						
acoustic resistance coefficient:						
R _w [dB]	27					
R _{A1} [dB]	24					
R _{A2} [dB]	22					
acoustic absorption coefficient α_w	0,15					
Leakproofness						
Air permeability: pressure	n = 1,1983, C = 0,0022					
Air permeability: suction	n = 1,0141, C = 0,0036					
Blowing rain resistance	A class - absolute leakproofness at 1,200 Pa					

* modular width available on an individual order.

** maximum length depending on the panel colour – see the "Tips for colour selection" section

*** panels sewn by screws on both sides every 150 mm