

IzoGold MWF L/C

Wall sandwich panel with insulation core made of double density mineral wool
- hidden screw fasteners.

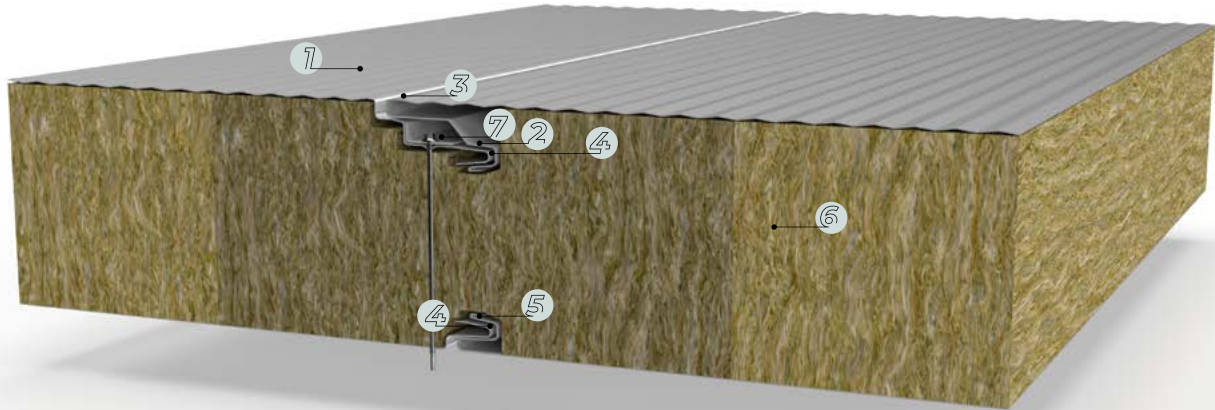
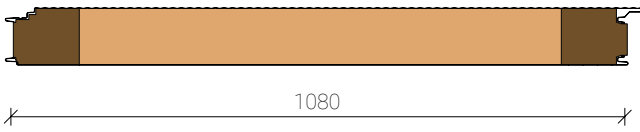

1 Profiled lining with a unique surface design.

5 Profiled edges facilitate assembly and ensure proper thermal insulating power.

2 Hidden fastener gives the facade a uniform appearance.

6 Insulation core made of hard and incombustible mineral wool (MWF). The core is made of stone wool of two densities (80 kg/m³ and 110 kg/m³)

3 Large bend radii guarantee durability of lining protective coatings.

7 L-02 fastener ensuring load distribution.

4 Double panel lock guarantees best fire resistance properties.

Mineral wool core, $\lambda \approx 0,039 \text{ W/m}^{\circ}\text{K}$.

Steel sheet lining with anticorrosive protection depending on the intended use.

- production halls
- storage buildings
- commercial halls
- shopping centres
- farm facilities

Suitable for building external and internal walls of industrial buildings.

Vertical or horizontal installation.

Mechanical properties

<i>thickness [mm]</i>	60	80	100	120	150	180	200
<i>modular width [mm]</i>	1080 or 1000*						
<i>total width [mm]</i>	modular width + 45 mm						
<i>length [mm]</i>	2000 - 13000**						
<i>weight 0,5/0,4 [kg/m²]</i>	13,9	15,7	17,4	19,1	21,7	24,3	26,0
<i>weight 0,5/0,5 [kg/m²]</i>	14,8	16,6	18,3	20,0	22,6	25,2	26,9
<i>weight 0,6/0,6 [kg/m²]</i>	15,7	17,4	19,1	20,9	23,5	26,1	27,8

Insulating power

<i>U [W/m²K]*</i>	0,63	0,47	0,39	0,32	0,26	0,22	0,19

Leakproofness

<i>Air permeability: pressure</i>	n = 0,7578, C = 0,0335
<i>Air permeability: suction</i>	n = 0,7778, C = 0,0115
<i>Blowing rain resistance</i>	A class - absolute leakproofness at 1,200 Pa
<i>Corrosion resistance</i>	External claddings: RC3, internal claddings: RC2***

Burning behaviour

<i>fire resistance</i>	EI 60
<i>reaction to fire</i>	A2-s1,d0
<i>fire propagation</i>	NRO

* modular width available on an individual order.

** maximum length depending on the panel colour – see the "Tips for colour selection" section

*** The RC2 corrosion resistance class refers to standard corrosion protection used only on internal cladding. Higher corrosion resistance category on special order.